

Fully automatic PALLETISER

Model: MK10

**High-speed palletiser that can palletise
up to 400 pallet layers per hour**

- › High-speed palletisation with minimal footprint
- › Increased efficiency – increased earnings
- › Reduces employee strain
- › Durable and reliable

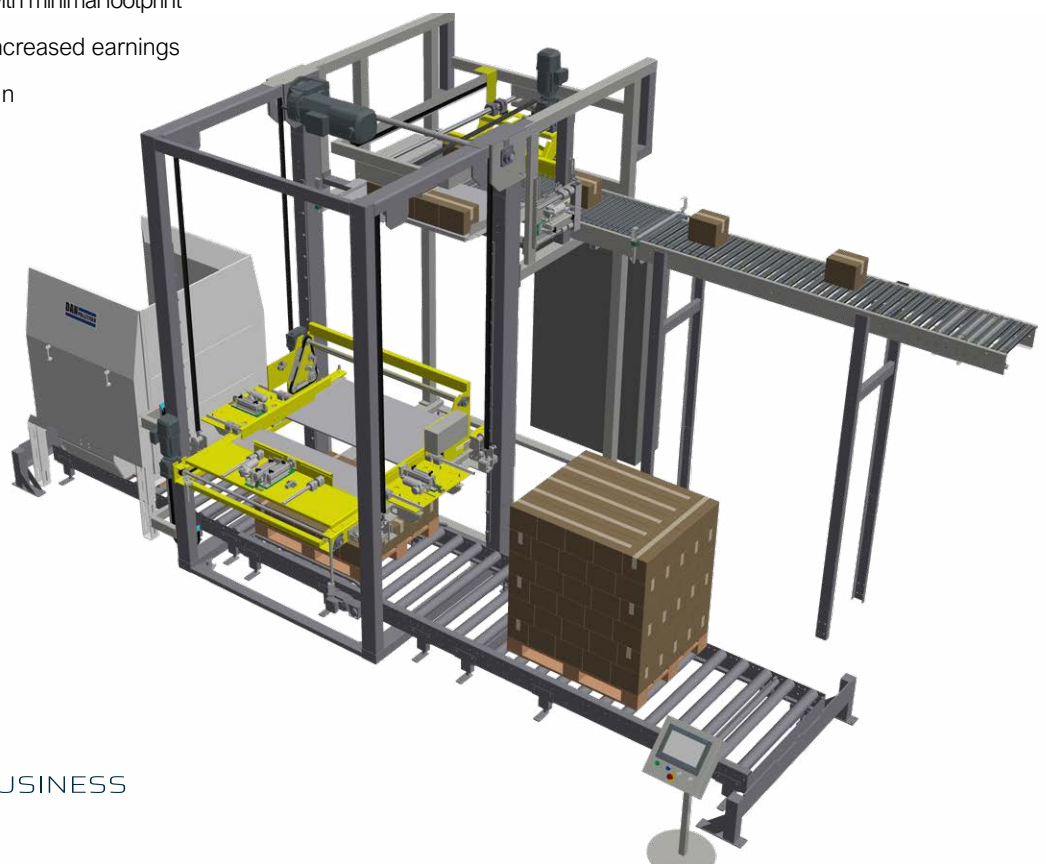

Fully automatic PALLETISER

Model: MK10

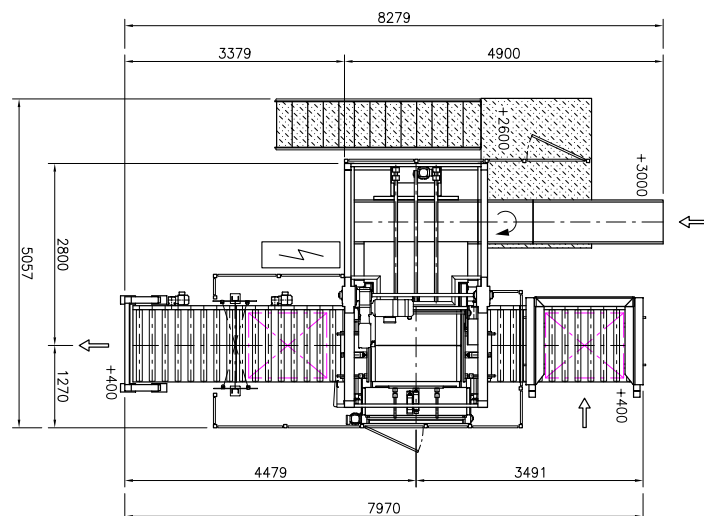

MK10 can palletise:



Newspapers and magazines



Boxes



Open boxes



SRS Boxes
(reusable plastic boxes)



Bags and sacks



Trays



Shrink-wrapped products

Configuration

An MK10 is a high-speed palletiser that can palletise EUR pallets, ½ pallets, ¼ pallets, and industrial pallets (1000 mm×1200 mm). It palletises up to 400 pallet layers per hour and can store 99 different pallet patterns via the operator panel.

An MK10 palletiser is built as a “high loader”, i.e. the infeed conveyors are at the top of the pallet loader, and the loading plate moves down to the pallet to unload. It has been specially developed for places where space is tight but production rates are high.

One thing often precludes the other, as high-capacity palletising systems usually take up a lot of space, but not if you choose an MK10. It can be designed as a multi-palletiser so that it can palletise products from several production lines at the same time.

It is modular, meaning you can adapt it to its surroundings in the production hall, as infeed conveyors and pallet conveyors can be assembled, angled, raised and lowered in several ways.

CONFIGURATION

Capacity	400 pallet layers/hour
Pallet size	800 x 1200 mm 1000 x 1200 mm 600 x 800 mm 400 x 600 mm
Pallet patterns	99 pcs



See the MK10 palletiser in action here

Function

The products are taken from the packing machines via the inlet conveyor and into the palletiser. The pallet layers are then formed, after which they are gently pushed out onto the loading plate. At the same time, an empty pallet from the pallet magazine is driven into the palletiser and the pallet layer is transferred from the loading plate onto the pallet. At no time the product is lifted from the ground, which makes the pallet loader the most gentle form of palletisation.

The pallet layers are automatically adjusted to ensure the palletised pallets are dead straight. The pallet can then be wrapped, driven to the warehouse, and transported out to the customer without the products falling over or being damaged.

PRODUCTS

Max weight	250 kg / pallet layer
Max pallet height	2300 mm
Max box size	800 mm diagonal

Accessories

Additional equipment can be purchased for the MK10 to meet the need for efficient palletisation in almost all areas.

For example:

- › Sheet dispensers – for placing paper or cardboard sheets on the pallet and/or between layers
- › Handle shutters – for closing the handles on stackable plastic boxes before palletisation
- › Full pallet stackers – for putting two filled pallets on top of each other after palletisation

We also supply roller and chain conveyors for transporting empty and filled pallets, and we can deliver label applicators, spiral elevators, and shrink-wrappers.

In-house production

Experienced mechanical and electrical engineers construct the machine, which is manufactured and assembled in our workshops. We are also responsible for constructing and programming the equipment.

All machines are assembled, tested and approved by the customer before delivery to ensure everything works as it should.

We deliver the palletiser, install and run it at the customer's premises, and train the staff so they can operate it themselves.

Our service department offers various types of service agreements so that we can regularly maintain the palletiser, ensuring that it always runs optimally. We also provide 24-hour assistance if needed.

DAN Palletiser A/S

Industrivej 12
 DK-4241 Vemmelev
 +45 58 38 21 93
www.dan-palletiser.dk/en